

A: EXTEND TRIPOD LEGS.
B: POSITION GRIP BALL HEAD.

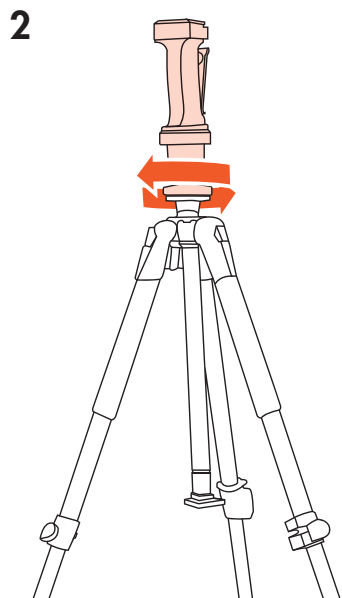

ROTATE GRIP BALL HEAD
UNTIL SECURE ON TRIPOD.

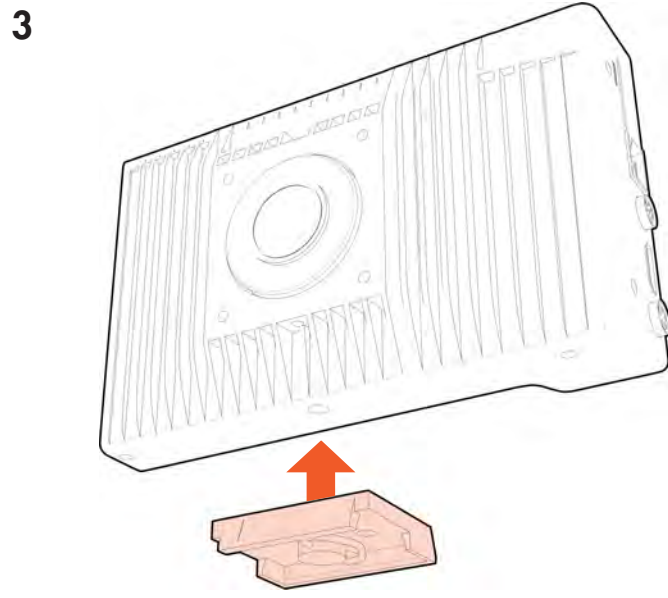

SECURE THE MOUNTING ADAPTER ON TO CAMERA.
ENSURE A TIGHT FIT.

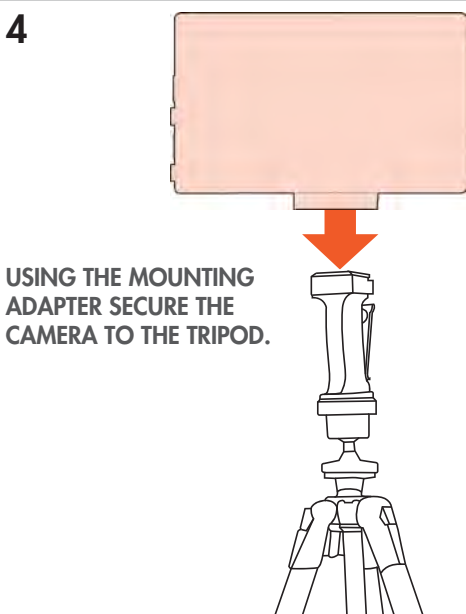

USING THE MOUNTING
ADAPTER SECURE THE
CAMERA TO THE TRIPOD.

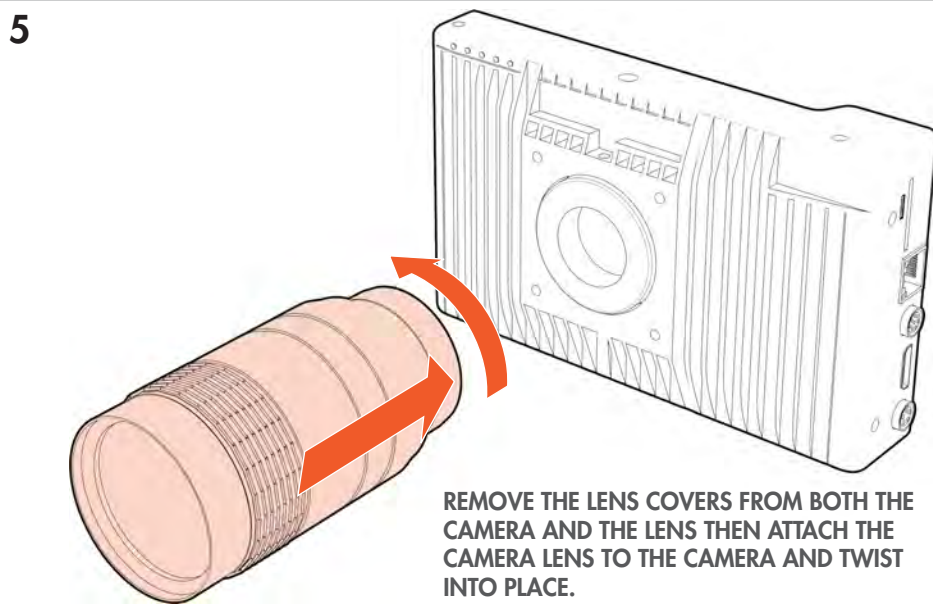

REMOVE THE LENS COVERS FROM BOTH THE
CAMERA AND THE LENS THEN ATTACH THE
CAMERA LENS TO THE CAMERA AND TWIST
INTO PLACE.

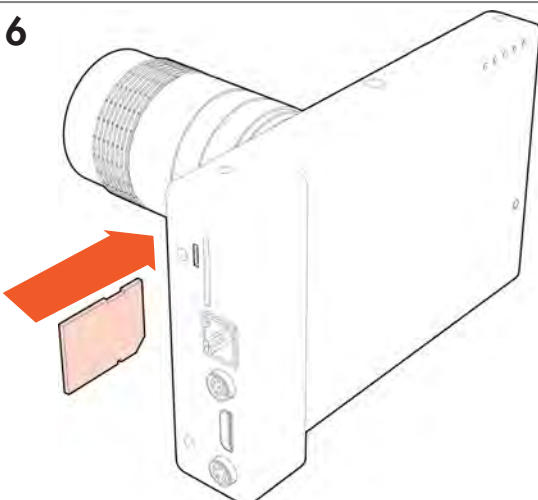

OPEN THE SIDE DOOR AND INSERT THE SD CARD.

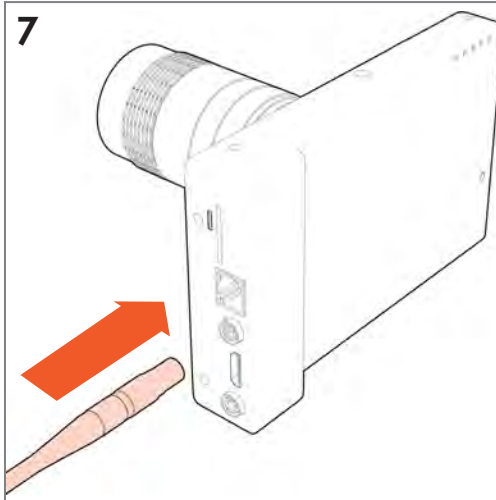

INSERT THE I/O CABLE.

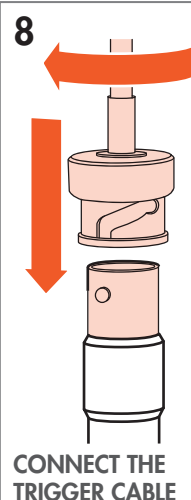

CONNECT THE
TRIGGER CABLE
TO THE I/O CABLE.

9

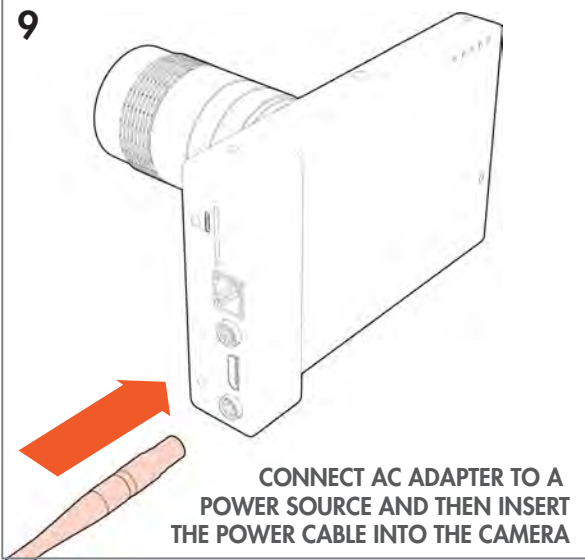

10

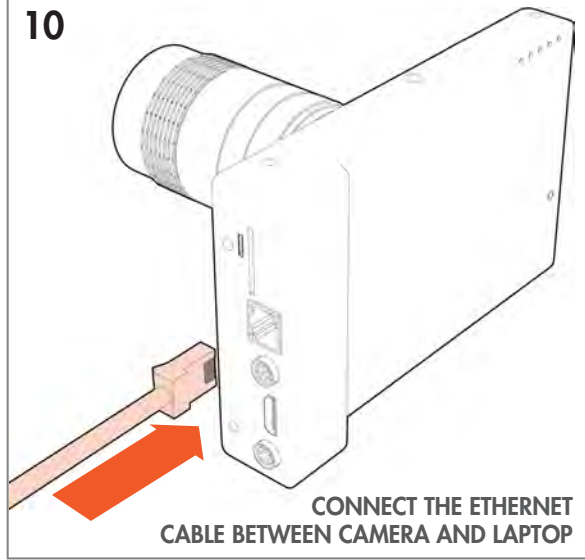

13

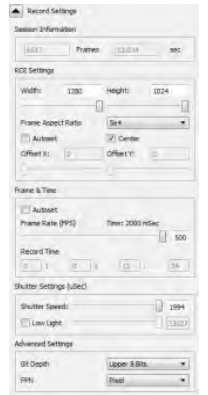

OPEN FASMOTION OR ANY BROWSER, FIND THE CAMERA AND SELECT THE SUITABLE FRAME RATE AND RESOLUTION

11

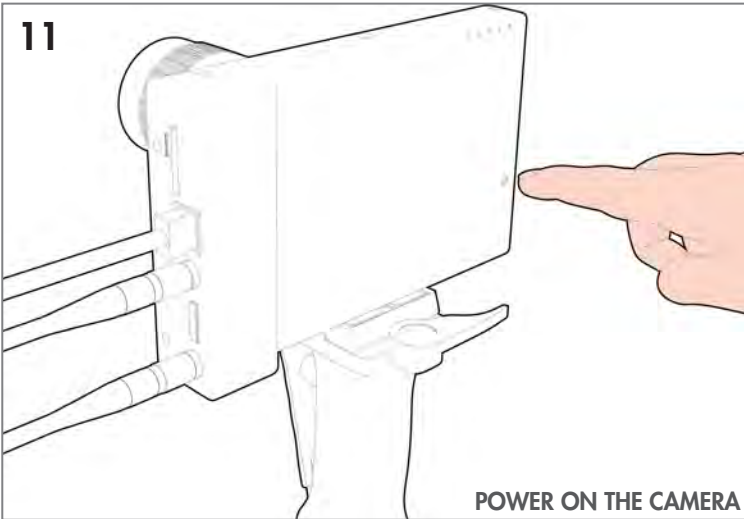

14



PRESS THE TRIGGER SWITCH AND THE SUBJECT WILL BE VIDEO RECORDED.

12

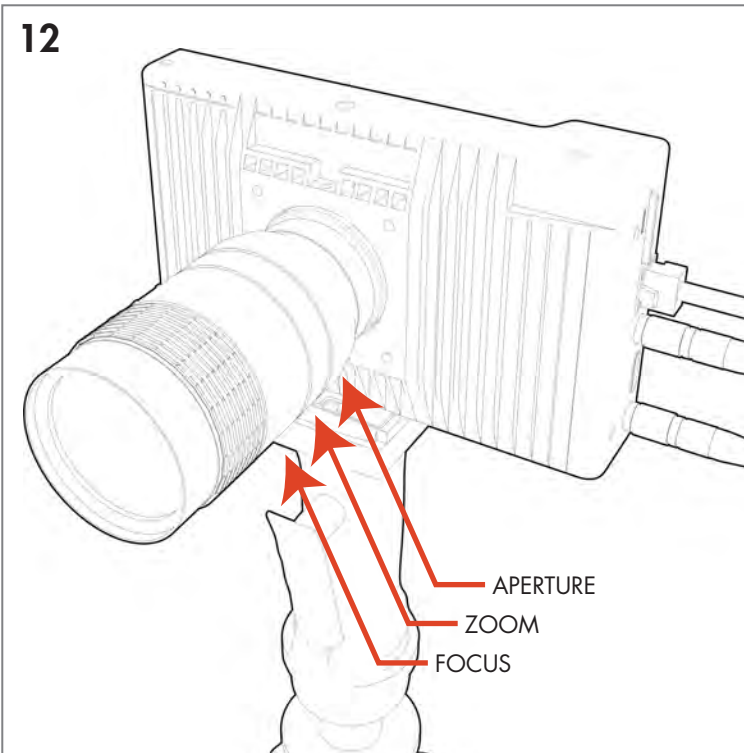

SET THE APERTURE TO THE LOWEST NUMBER AND THEN ADJUST THE ZOOM, APERTURE AND FOCUS ON THE LENS TO OBTAIN THE PERFECT PICTURE

15



REVIEW THE VIDEO WITH THE ABOVE BUTTONS ON THE LAPTOP SCREEN. WHEN READY PRESS THE SAVE BUTTON.

16



PRESS THE DESTINATION BUTTON AND CHOOSE THE SD CARD. PRESS THE SAVE BUTTON TO SAVE THE VIDEO.